

826-2130, Cordset Removal Kit

This kit removes an unnecessary cordset and routes power between transformer boxes with a provided wiring harness. Follow these instructions to install the kit:

In Kit 826-2130		
Part No.	Description	Qty
106-5373	Harness	1
220-0211	Block Off Plate	1
805-1594	Diagram	1
809-0361	Screw	2
819-6130	Instructions	1

2. Remove the right transformer box lid and cut a $\frac{3}{4}$ " hole in the left side of the top. Cut a $\frac{3}{4}$ " hole in the right side of the left transformer box.

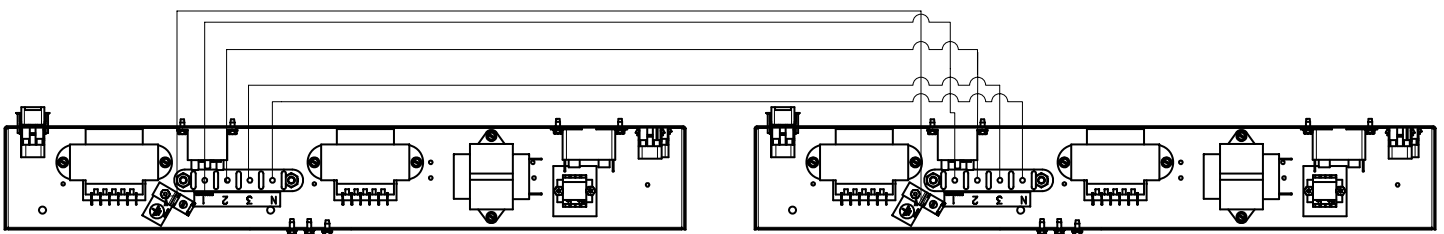
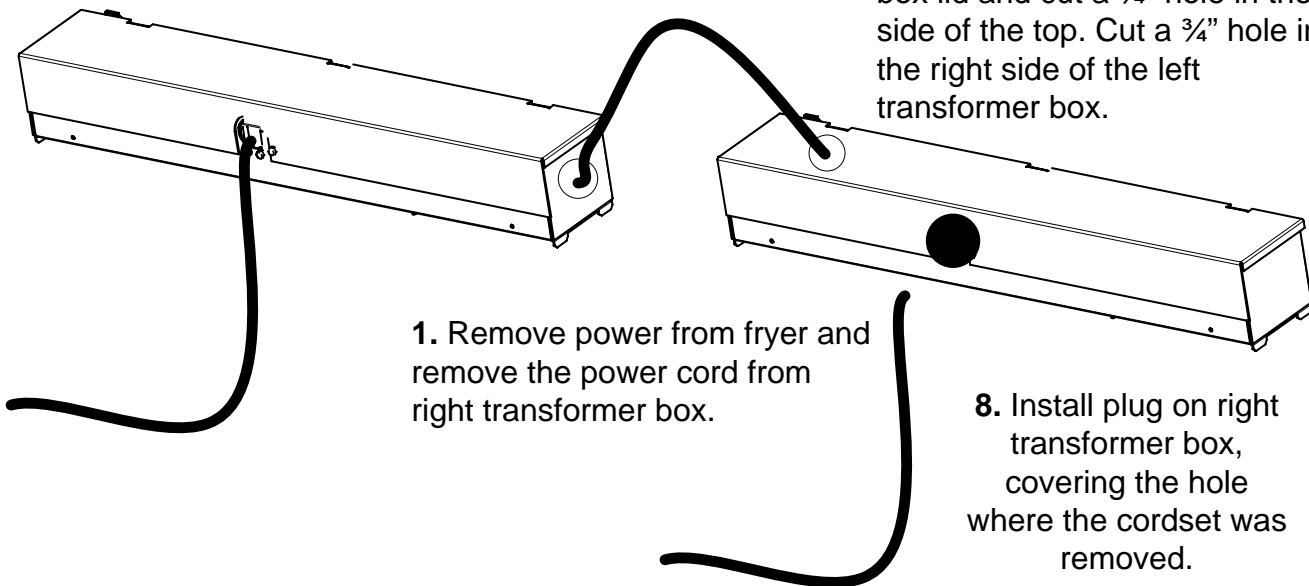

- 3.** Remove the lid from each box and connect the provided wire harness to the terminal block in the left transformer box. Follow the color code established by the power cord.
- 4.** Attach the strain relief to the $\frac{3}{4}$ " holes in the transformer boxes.
- 5.** Route the wire from the left transformer box terminal block to the right transformer box.
- 6.** Connect the wires to the terminal block of the right transformer box, using the same configuration seen on the left transformer box.
- 7.** Replace the lids.